



**PUBLIC WORKS  
STANDARD DRAINAGE  
AND DRIVEWAY  
DETAILS  
2013**

**ADOPTED BY CITY COMMISSION**

**ORDINANCE 13-761 ON 12-12-13**

SUBSTANTIAL EFFORT HAS BEEN MADE TO ENSURE THE INFORMATION CONTAINED IN THESE STANDARDS IS ACCURATE. HOWEVER, THE CITY OF ANNA MARIA CANNOT ACCEPT RESPONSIBILITY FOR ANY ERRORS OR OVERSIGHTS IN THE USE OF THE MATERIAL OR IN THE PREPARATION OF THE ENGINEERING PLANS. THIS PUBLICATION IS INTENDED FOR USE BY PROFESSIONAL PERSONNEL COMPETENT TO EVALUATE THE SIGNIFICANCE AND LIMITATIONS OF ITS CONTENTS AND BE ABLE TO ACCEPT RESPONSIBILITY FOR THE APPLICATION OF THE MATERIAL IT CONTAINS.

THE DESIGNER MUST RECOGNIZE THAT NO HANDBOOK OR CODE CAN SUBSTITUTE FOR EXPERIENCED ENGINEERING JUDGEMENT. SOME OF THE RECOMMENDATIONS ARE UNDER FURTHER REVIEW AND MAY BE UPDATED LATER. USERS OF THESE STANDARDS ARE ENCOURAGED TO OFFER COMMENTS TO CITY OF ANNA MARIA PUBLIC WORKS DEPT ON THE CONTENTS OF THIS PUBLICATION AND SUGGESTIONS FOR CHANGES IN FUTURE EDITIONS.

THESE STANDARDS ARE UNDER CONSTANT REVIEW AND ARE SUBJECT TO CHANGES APPROVED BY THE DIRECTOR OF PUBLIC WORKS. THE DIRECTOR OF PUBLIC WORKS SHALL INTERPRET THESE STANDARDS, AS NEEDED, FOR APPLICATION AND RESOLUTION OF CONFLICTS.

NOTE: ALL CONSTRUCTION AND STANDARDS REFERENCED WITHIN SHALL MEET OR EXCEED F.D.O.T. ROADWAY AND TRAFFIC DESIGN STANDARDS (LATEST REVISION) AND F.D.O.T. STANDARD SPECIFICATIONS FOR ROAD AND BRIDGE CONSTRUCTION (LATEST REVISION), UNLESS OTHERWISE NOTED.

CITY OF ANNA MARIA  
PUBLIC WORKS DEPT

REV.BY	DATE

12/12/13  
DATE OF ADOPTION

DISCLAIMER  
SHEET

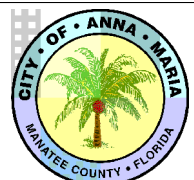

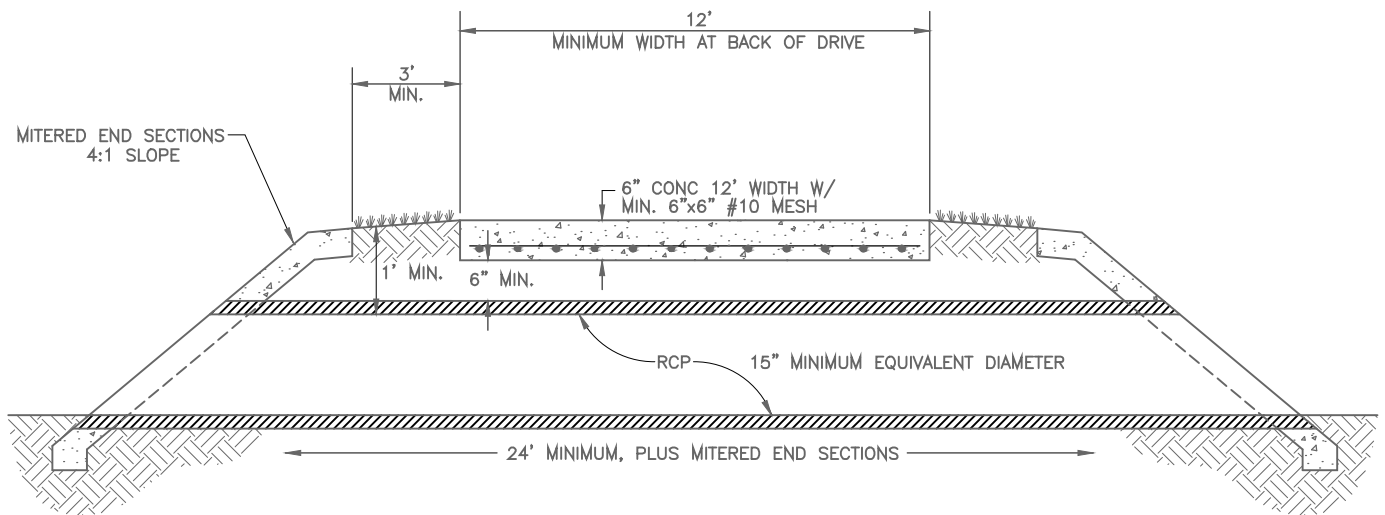

### TYPICAL DRIVEWAY

VARIABLES: C.M.P. WILL NOT BE ALLOWED WITHIN THE RIGHT-OF-WAY.  
 R.C.P. WILL REQUIRE A MINIMUM 6" OF COVER BENEATH BOTTOM OF DRIVEWAY, FOR A TOTAL OF 1' OF COVER. HDPE PIPE IS ACCEPTABLE IN LIEU OF RCP.  
 ALTERNATIVE DRIVEWAY MATERIALS MAY BE UTILIZED IN ACCORDANCE WITH THESE STANDARDS.

- NOTE: 1) GRADES AND LOCATIONS MUST BE REVIEWED AND APPROVED BY PUBLIC WORKS FOR ALL PIPE INSTALLATIONS
- 2) ACTUAL REQUIRED PIPE DIAMETER WILL BE BASED ON THE FLOW RATE REQUIRED TO PASS THROUGH PIPE SO AS NOT TO IMPOUND WATER UPSTREAM.
- 3) PIPE SIZE TO BE DETERMINED AND APPROVED BY PUBLIC WORKS.

DRAWN BY:	DATE:
LTB	11-2013
REVISION NO.	SCALE:
	NTS

CITY OF ANNA MARIA  
 PUBLIC WORKS  
 STANDARD DETAIL 1.010





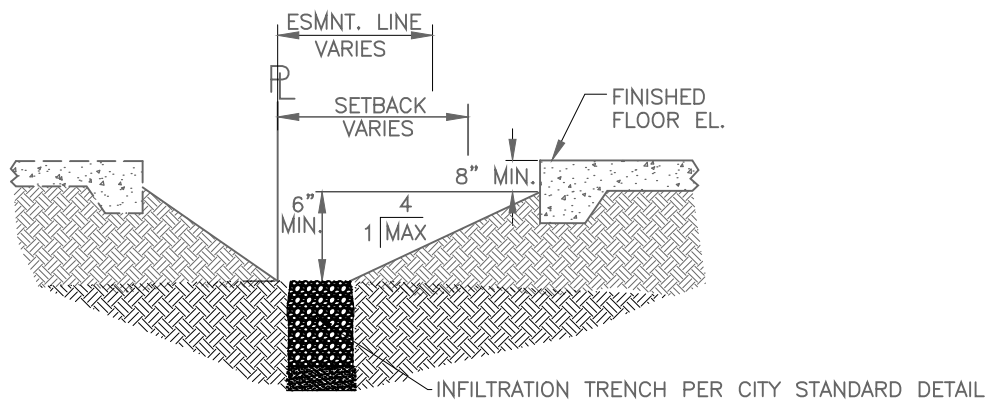
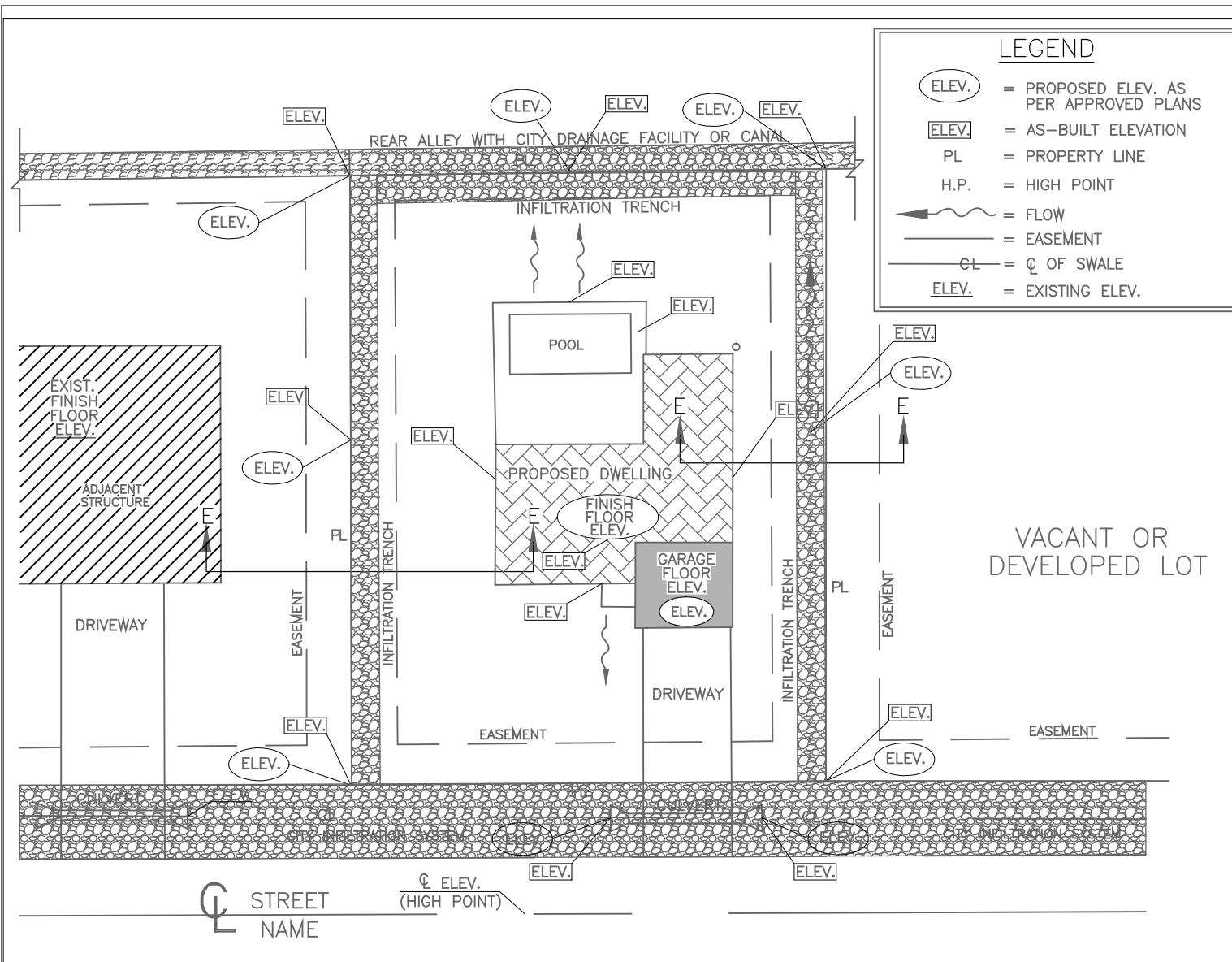

CROSS SECTION E-E

DRAWN BY:	DATE:
LTB	11-2013
REVISION NO.	SCALE:
	NTS

CITY OF ANNA MARIA  
PUBLIC WORKS  
STANDARD DETAIL 1.02



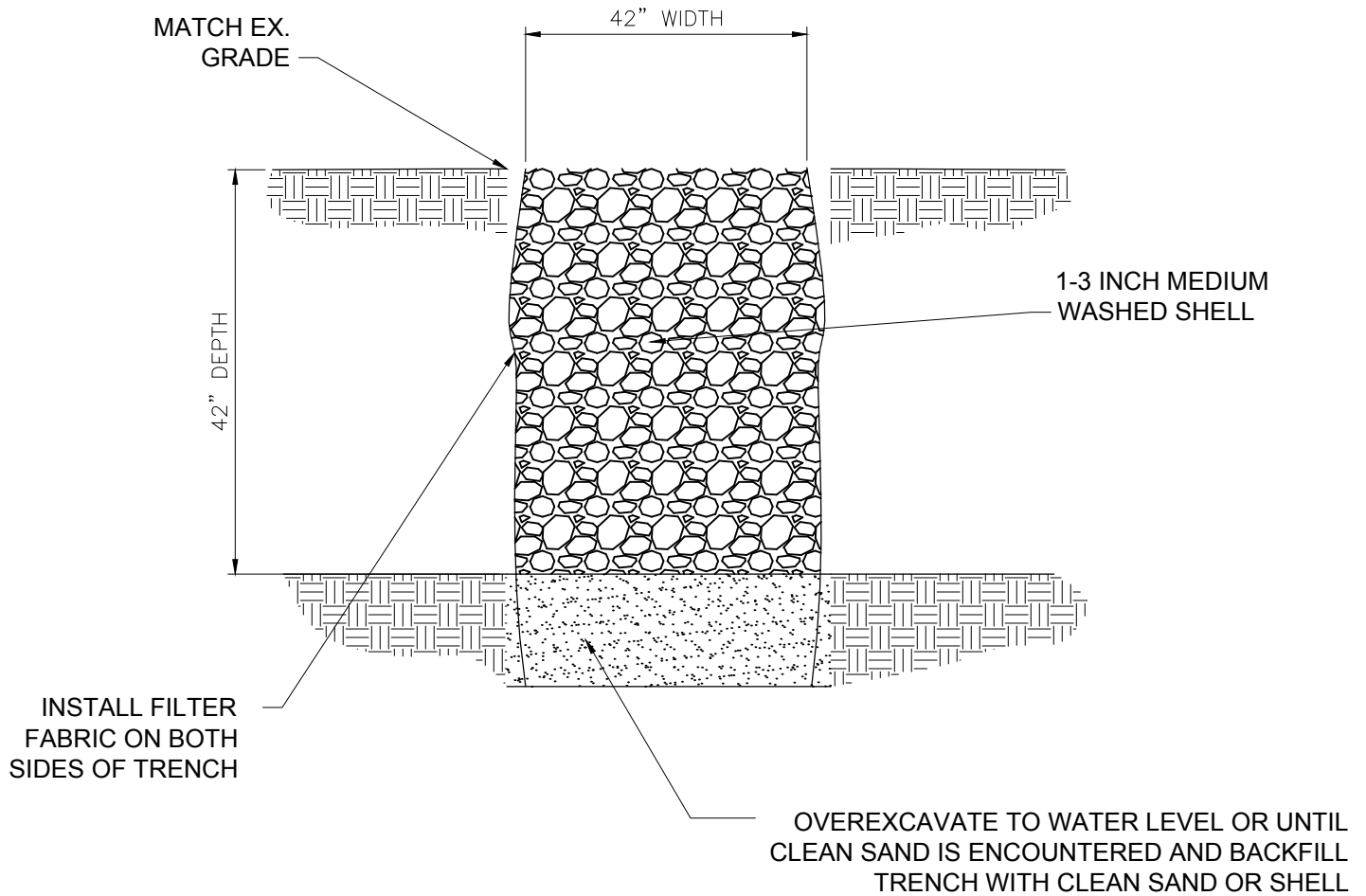

## TYPICAL INFILTRATION TRENCH

NTS

DRAWN BY:	DATE:
LTB	11-2013
REVISION NO.	SCALE:
	NTS

CITY OF ANNA MARIA  
PUBLIC WORKS  
STANDARD DETAIL 1.03



MATCH EX.  
GRADE AT  
PROPERTY  
LINE

WIDTH VARIES, SEE PLAN

6" DEPTH 250  
SAND/SHELL MIX

18" DEPTH

12" DEPTH # 57 STONE

INSTALL FILTER  
FABRIC ON BOTH  
SIDES OF TRENCH  
AND BELOW TOP  
LAYER OF 250  
SAND/SHELL MIX

OVEREXCAVATE TO WATER LEVEL OR UNTIL  
CLEAN SAND IS ENCOUNTERED AND BACKFILL  
TRENCH WITH CLEAN SAND OR SHELL

## HEAVY DUTY INFILTRATION TRENCH

NTS

DRAWN BY:

LTB

REVISION NO.

DATE:

11-2013

SCALE:

NTS

CITY OF ANNA MARIA  
PUBLIC WORKS  
STANDARD DETAIL 1.04

