

Section 16, Township 34 South, Range 16 East

Public Records of MANATEE County, Florida

Date 9-5-85 For JOE CICCARELLO

I, The Undersigned Registered Land Surveyor, do hereby certify that this Plat is a true representation of the lands described and shown hereon to the best of my knowledge and belief. *

By: Geo. Mills
Registered State of Florida Professional Land Surveyor No. 1735

RECHECK CERTIFICATE:

The buildings shown on attached survey plat checked (9-5-85) and found located as shown.

Geo. Mills
BOUNDARY & LOCATION SURVEY

ADDRESS:

120 BEACH AVENUE

* and adheres to the minimum technical standards for land surveying in the State of Florida, (Chapter 21-HH-6, F.A.C.).

LOCATION SKETCH

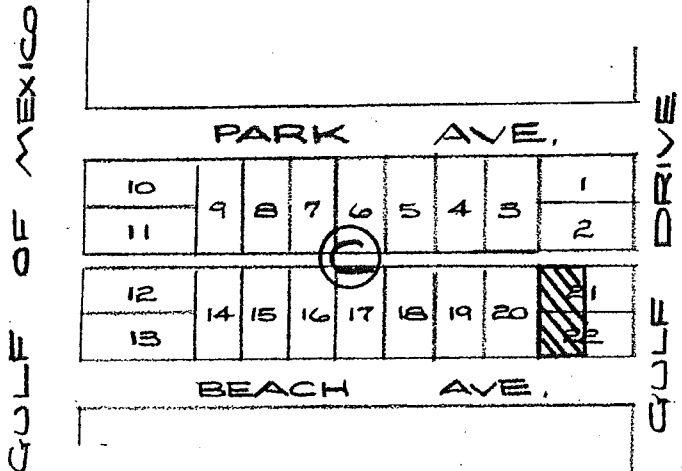

ELEVATIONS:

COND. EL. 5.0
BOTTOM BEAM EL. 13.06
TOP BEAM EL. 14.65
1ST HABITABLE FLOOR ELEV. 14.94
BOTTOM SLAB EL. 5.36

FLOOD ZONE: THE SUBJECT LAND LIES IN ZONE "A-11" (areas of 100-year flood) of the Flood Insurance Rate Map, Community Panel 125087 0003-D (elevation of 9 feet required).

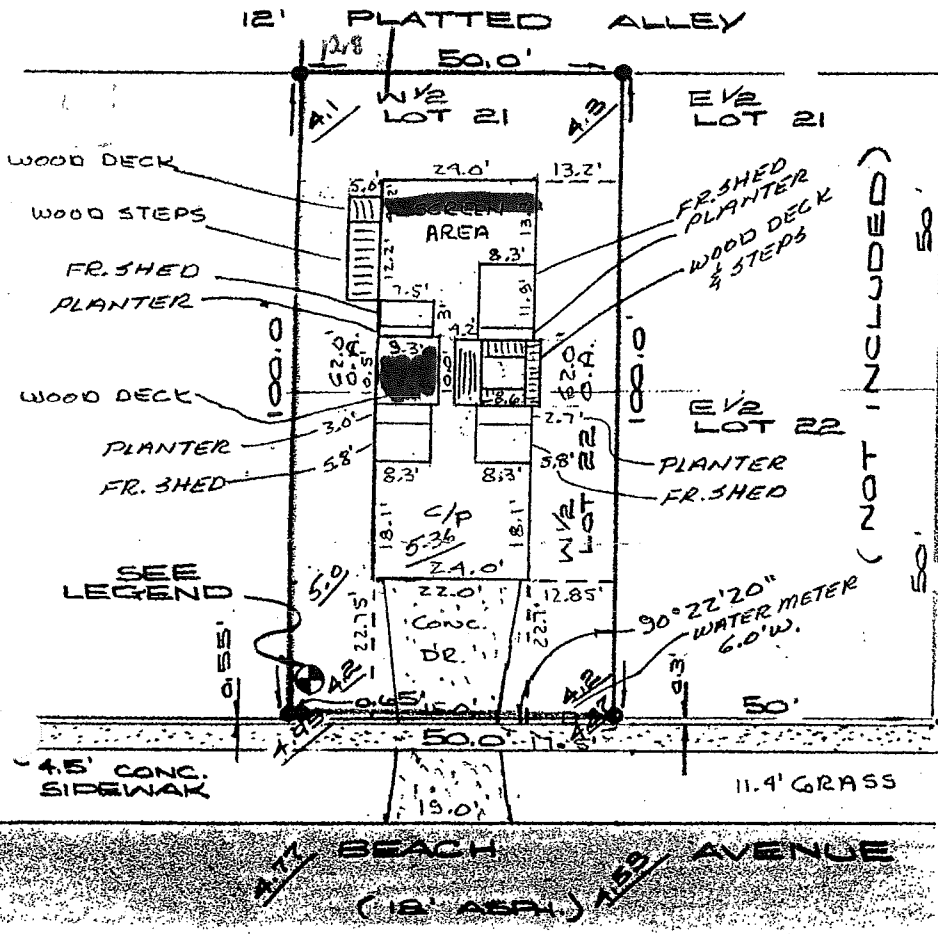

1ST LEVEL - CONC. SLAB AS SHOWN WITH C. B. PILES
2ND LEVEL - FRAME RES.

RECEIVED
JAN 26 2004

LEGEND:

- - IRON ROD
- - IRON PIPE
- P.O.L. - POINT ON LINE
- ⊕ - BENCH MARK NAIL IN PALM ELEV. 5.38 REFERS TO N.G.V.D. DATA