

ANNA MARIA BOARDWALK - CONCEPTUAL SCHEME

SCALE: 1"=20'-0"

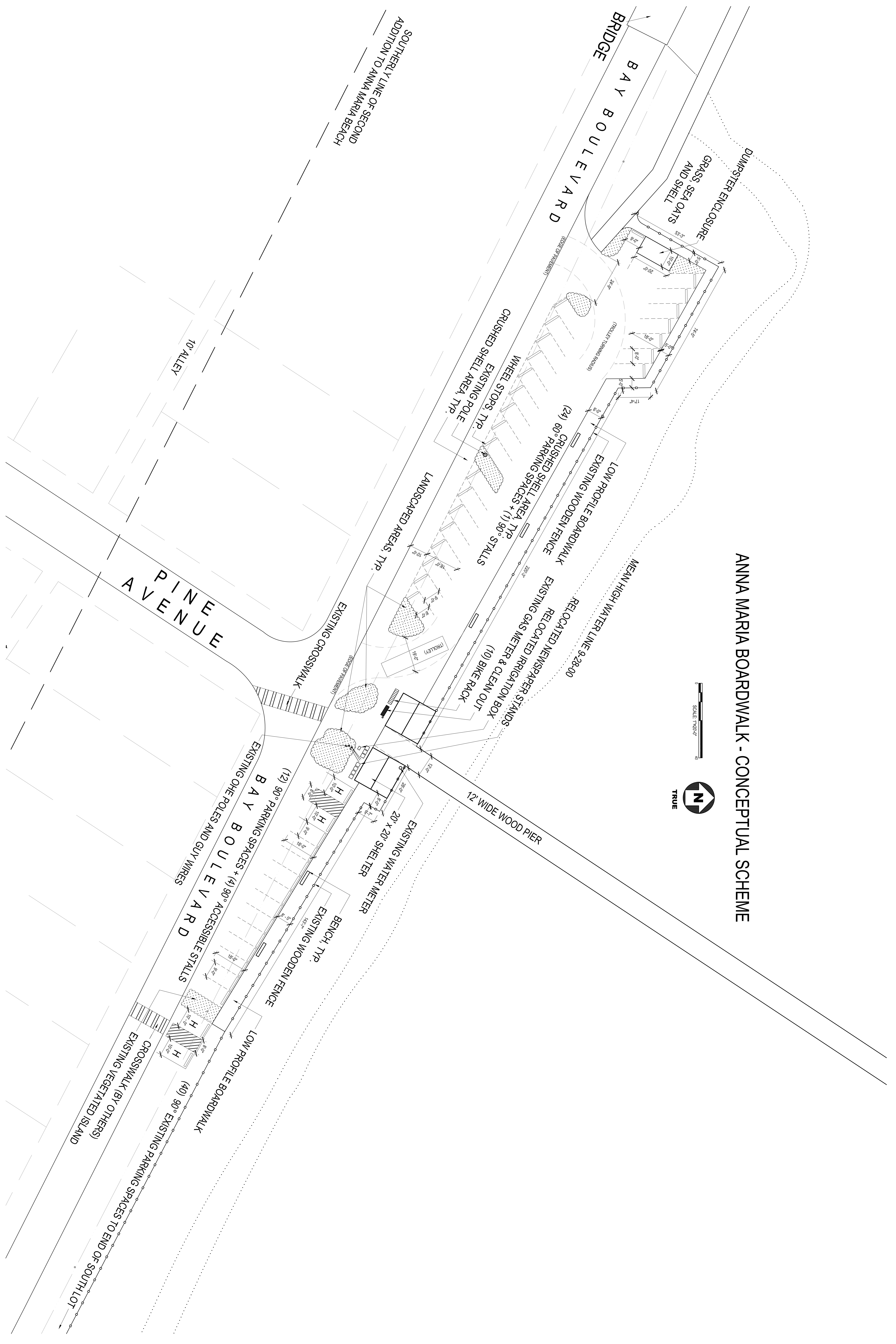

SOUTHERLY LINE OF SECOND ADDITION TO ANNA MARIA BEACH

BRIDGE

BAY BOULEVARD

GRASS, SEA OATS AND SHELL

DUMPSTER ENCLOSURE

(EDGE OF PAVEMENT)

(TROLLEY TURNING RADIUS)

WHEEL STOPS, TYP.
EXISTING SHELL AREA, TYP.

LANDSCAPED AREAS, TYP.

EXISTING CROSSWALK
(EDGE OF PAVEMENT)

RELOCATED NEWSPAPER STANDS
RELOCATED GAS METER & CLEAN OUT
(10) BIKE RACK

MEAN HIGH WATER LINE 9-28-00

12' WIDE WOOD PIER

EXISTING WATER METER
20' x 20' SHELTER

BAY BOULEVARD
EXISTING ONE POLES AND GUY WIRES

(12) 90° PARKING SPACES + (4) 90° ACCESSIBLE STALLS

BENCH, TYP.
EXISTING WOODEN FENCE

LOW PROFILE BOARDWALK
CROSSWALK (BY OTHERS)
EXISTING VEGETATED ISLAND

(40) 90° EXISTING PARKING SPACES TO END OF SOUTH LOT